

Plat of Survey

of  
Lot H2 of Country Club Estates, Addition "H",  
a subdivision located in the Southwest 1/4 of the Southwest 1/4 of Section 14, Town 1  
North, Range 16 East, Village of Fontana-on-Geneva Lake, Walworth County, Wisconsin.

Surveyed for: @properties  
880 West Main Street  
Lake Geneva, Wisconsin. 53147

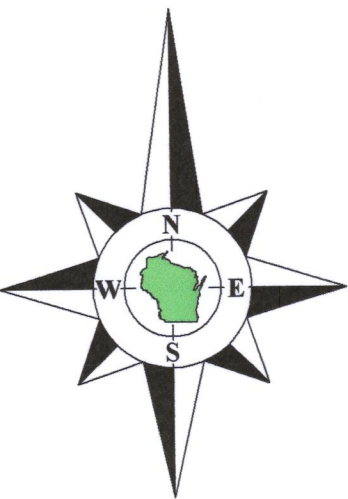

Bearings referenced to the Northerly line Tarrant Drive, recorded as S62°50'00"W  
on the plat of Country Club Estates, Addition "H", which produces a bearing of  
N89°39'47"E on the North line of the of the Southwest 1/4 of Section 14-1-16,  
recorded as N88°23'55"E in the Wisconsin State Plane Coordinate System,  
South Zone, (NAD-27).

Coordinates are referenced to the Wisconsin State  
Plane Coordinate System, South Zone, (NAD-27).

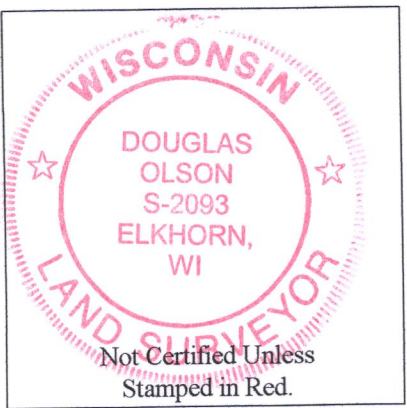

Notes:

- 1) This Plat of Survey is not certified unless signed and sealed in red ink.
- 2) This survey is subject to Wisconsin lien laws. This Plat of Survey is the notice of intent to file lien. Lien waiver required.
- 3) The Survey Date shown on this Plat of Survey is the completion date of the field work.

Copyright ©2019 by Olson Land Surveying, LLC.

All rights reserved. No part of this survey plat may be reproduced or transmitted in any form by any means - graphic, electronic, or mechanical, including photocopying, tracing, or information storage and retrieval systems - without permission in writing from Douglas G. Olson, Olson Land Surveying, LLC.

I hereby certify that I have surveyed the above described property in compliance with Chapter A-E 7 of the Wisconsin Administrative Code and that the map hereon is correct to the best of my professional knowledge and belief and shows the size and location of the property, its exterior boundaries, the location and dimensions of all visible structures thereon, boundary fences, apparent easements and roadways and visible encroachments, if any.

This survey is made for the exclusive use of the present owners of the property, and also those who purchase, mortgage or guarantee title thereto, within one year from the date hereof.

Douglas G. Olson  
Wisconsin Professional Land Surveyor - 2093

Survey Date: October 23, 2019.  
Revisions:

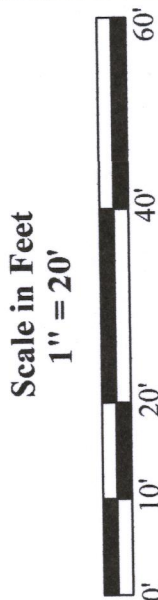

45 South Wisconsin Street | P.O. Box 322  
Elkhorn, Wisconsin. 53121  
Telephone: (262) 723-3434  
Facsimile: (262) 723-8044  
Email: doug@olsonsurveying.com  
Website: www.olsonsurveying.com

**OLSON**  
LAND SURVEYING, LLC  
Rural | Residential | Commercial

Legend of Symbols & Abbreviations	
North Arrow	North
Found County Section Corner	Section Corner
Found Iron Pipe	Iron Pipe
Found Iron Rod	Iron Rod
Found Nail in Road	Nail in Road
Found Nail in Foundation	Nail in Foundation
Found Nail in Pedestal	Nail in Pedestal
Found Nail in Lamp	Lamp
Found Nail in Asphalt Surface	Asphalt Surface
Found Nail in Concrete Surface	Concrete Surface

Sheet 1 of 1 Sheets  
Drawing Name:  
Job Reference Number  
2019.130

2019.130